

Upgrade your fleet TS4-R-O

Do you have underperforming systems in your fleet?

TS4-R-O is the most cost-effective way to improve the energy harvest of your underperforming systems.

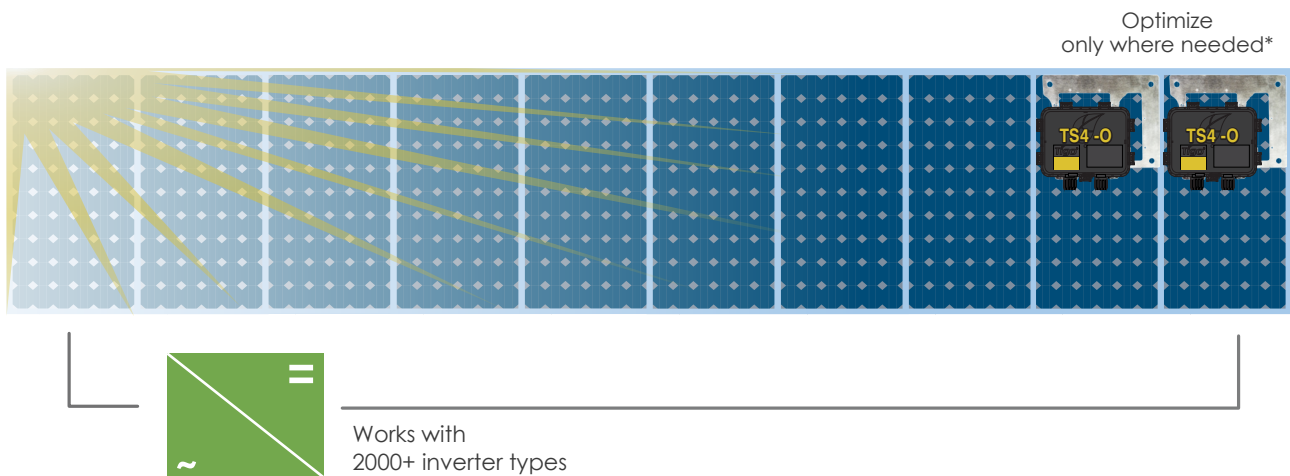

TS4-R-O enables you to upgrade an existing installation to improve energy harvest and lower O&M costs.

- Go back to your underperforming sites, and dramatically increase the energy harvest without making major changes to your existing array.
- Get immediate performance improvement because weak panels no longer pull down the production of the entire system. Recover on average 36% of power lost to partial shading.
- Module-level monitoring allows you to remotely detect and diagnose problems in the array, then determine if it is worth repairing.



* Selective deployment of optimization is intended for systems with a single string per MPPT. Use 100% deployment of optimization on parallel strings connected to the same MPPT. Rapid shutdown compliance requires 100% deployment of at least TS4-S.



Upgrade your fleet TS4-R-O

How a Tigo retrofit works

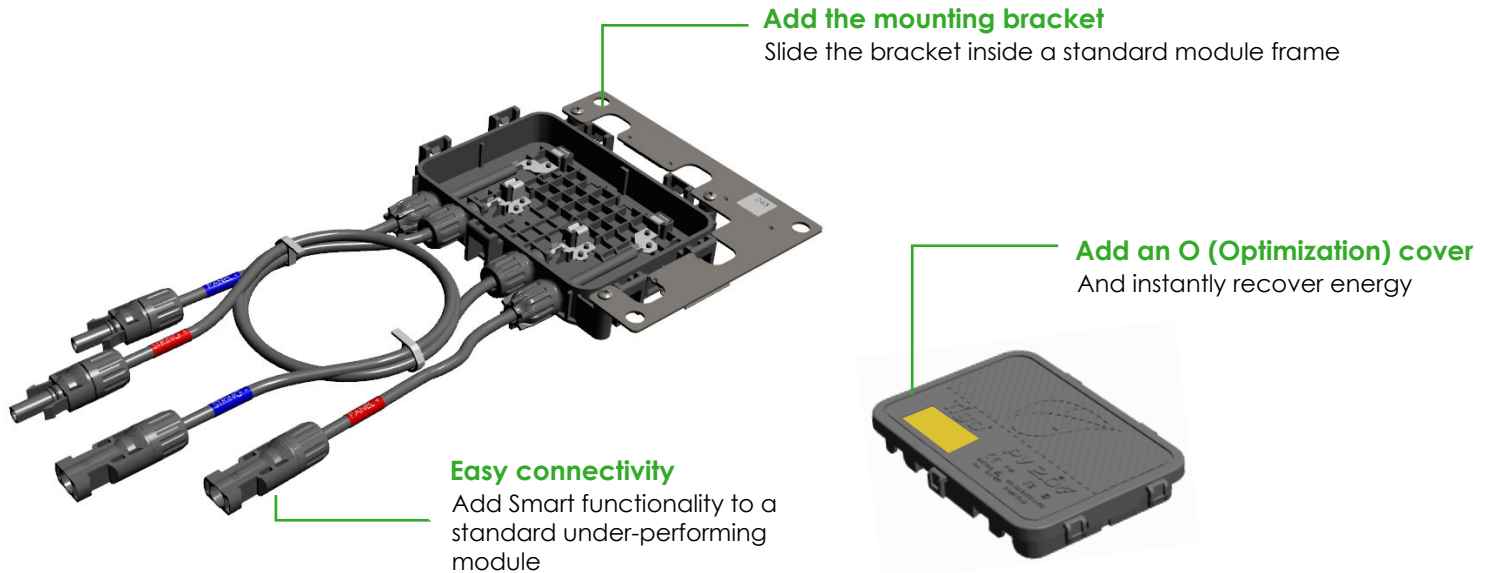

ELECTRICAL RATINGS

INPUT @ STC

| | |
|--|--------|
| Rated DC Input Power | 375W |
| Maximum PV Module Open Circuit Voltage(V _{oc}) | 52V |
| Maximum Current | 10A |
| PV Module V _{mp} range | 16-48V |

OUTPUT

| | |
|---|-------------------|
| Output Power Range | 0-375W |
| Output Voltage Range | 0-V _{oc} |
| Rapid Shutdown Verified (NEC 2014 690.12) | Yes |
| Impedance Matching Capability | Yes |
| Output Voltage Limit | No |
| Maximum System Voltage | 600/1000/1500V |
| Maximum Series Fuse Rating | 15A |

For sales info:

sales@tigoenergy.com or 1.408.402.0802

For product info:

Visit www.tigoenergy.com/products

For additional info and product selection assistance, Use Tigo's online design tool at www.tigoenergy.com/design



Tigo®

PV 2.0